

LEGEND

-  8' EXHIBIT TABLE
-  6' x 2.5' EXHIBIT TABLE
-  8' x 2.5' BUFFET TABLE
-  5' DIA. ROUND TABLE
-  2' DIA. TALL PUB TABLE
-  6' x 2.5' BEVERAGE STATION

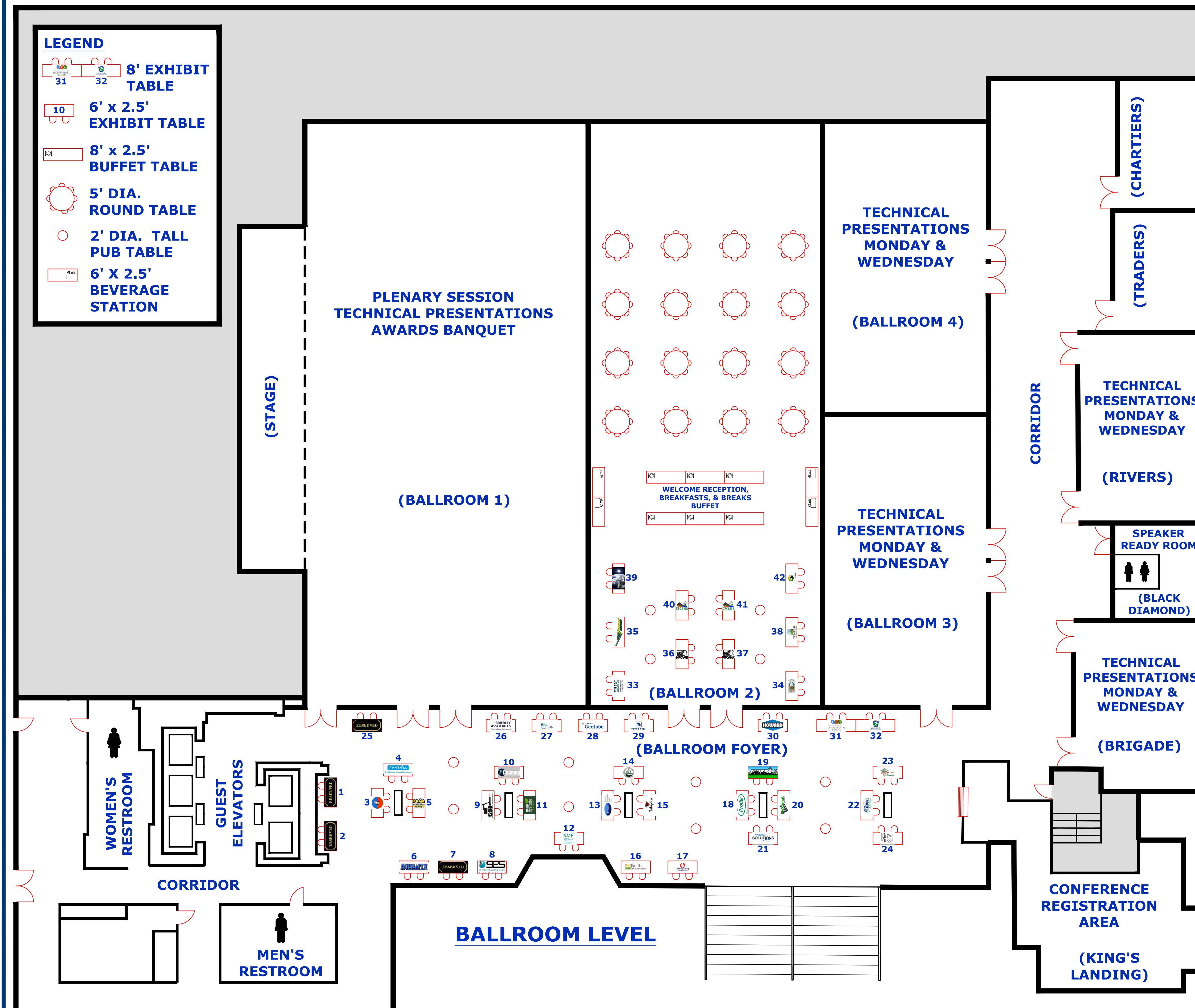

BOOTH NO.	ORGANIZATION	BOOTH NO.	ORGANIZATION
RESERVED	1. RESERVED	21.	TOPCON SOLUTIONS
RESERVED	2. RESERVED	22.	EAST COAST EROSION CONTROL
	3. MILLCREEK COALITION	23.	FULL CIRCLE MUSHROOM COMP
	4. RAMBOLL	24.	RESPEC
	5. FOAM CONCEPTS	RESERVED	25. RESERVED
	6. AQUAFIX		26. BRIERLEY ASSOCIATES, CORP.
RESERVED	7. RESERVED		27. THEIA
	8. SOMERSET ENVIRONMENTAL SOLUTIONS		28. TENCATE GEOTUBE
	9. GSI		29. TETRA TECH
	10. COSMOS TECHNOLOGIES		30. HOWARD PUMPING CONCRETE
	11. MARTLIN		31. WYOMING DEQ
	12. SME		32. PENNSYLVANIA DEPART. OF ENVIRONMENTAL PROTECTION
	13. COASTAL TECH SALES		33. SRBC
	14. OFFICE OF SURFACE MINING		34. ERNST
	15. TRI HYDRO		35. COMMONWEALTH EQUIPMENT
	16. EARTH CONSERVANCY		36. WPCAMR
	17. DAMIN PRINTING		37. WPCAMR
	18. PROFILE PRODUCTS		38. NASLR
	19. ARRIPPA		39. HARSCO
	20. FLEXAMAT		40. EPCAMR
			41. EPCAMR
			42. GOLDER



NO.	BY	DATE	DESCRIPTION



DATE: August 22, 2019	PLOT DATE: August 22, 2019	SCALE: 0 10' 20'
DRAWN BY: TAB	CHECKED BY: GCT	UNLESS OTHERWISE NOTED
ACAD FILE NAME:		

**NAAML P 2019 CONFERENCE
WYNDHAM HOTEL- PITTSBURGH, PA**

EXHIBITOR BOOTH LAYOUT

DRAWING NUMBER:
1 of 1